

SiLL-HaTM ST-4910

Oral Wellness System

Intended Use: SiLL-Ha is an oral health assessment instrument, providing information to assess gum health, tooth health and oral cleanliness. The instrument uses oral rinse (saliva) samples from individuals to perform this assessment. The instrument is not intended for diagnosis. It is to be used by dental health care professionals (such as dentist, hygienist, etc.) to help with patient education on oral wellness.



Refer to SiLL-Ha Operating Manual for complete instructions for use, warnings and cautions. For Customer or Technical Service, please call: 844.559.0842.



Caution: Patients should be advised to NOT drink, eat or brush their teeth two hours prior to the testing for best results.



Indicates a timed step in seconds.



Indicates action performed on PC.



Indicates action performed on SiLL-Ha.

START

1 **PC** Open the software on PC. Press and hold power button on SiLL-Ha to start.

2 **SH** Press and hold power button on SiLL-Ha to start.

3 **PC SH** Click [Test] to show patient information.

4 **PC** Enter patient information and chart number. Tap [OK] when complete to send.

5 **SH** Verify Chart No. on standby screen.

SAMPLE

6 Pour the oral rinse solution into a cup.

7 Ask patient to swish for 10 seconds and spit into cup.

8 Aspirate the sample with the dropper.

9 Drop sample on each pad of test strip, beginning with yellow pad.

TEST

10 **SH** Procedure screen. Follow steps 1 - 5 to complete test.

1 Tap [Start] right after applying sample.

2 Remove excessive fluid. (10 s)

3 Remove the spacer. Set the strip on the holder. (30 s)

4 Testing. (260 s)

5 Completed.

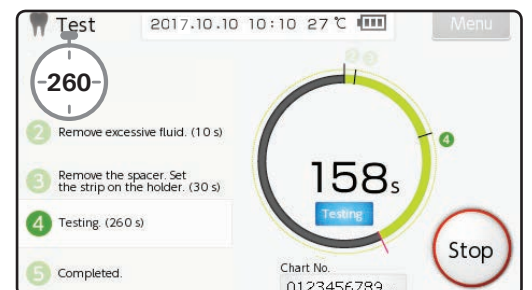
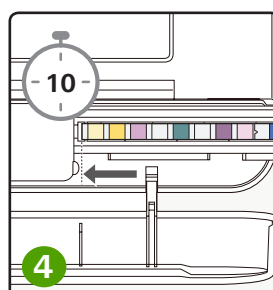
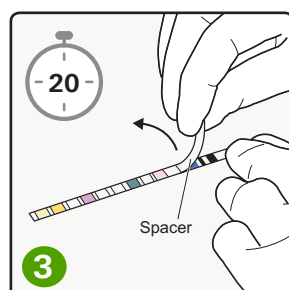
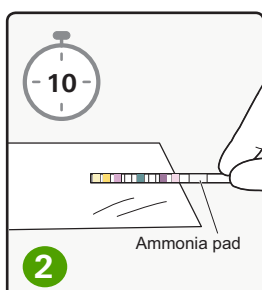

TEST RESULTS

PC



11

The test results will show on the PC when measurement is complete.

PRINT

PC



12

Printing the result sheet is optional at this point. Choose [Print] or save as PDF.

POWER OFF

SH

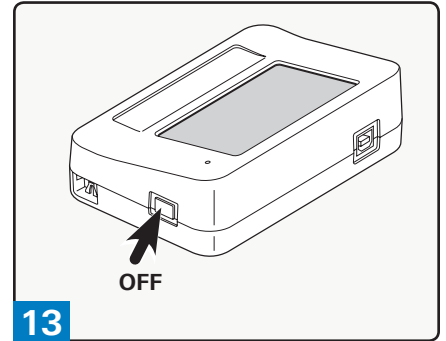

13

When all tests and cleaning are complete, power off the instrument. Press and hold the power button of the instrument. The test strip holder will retract and the display will turn off.

CLEANING THE SiLL-Ha INSTRUMENT

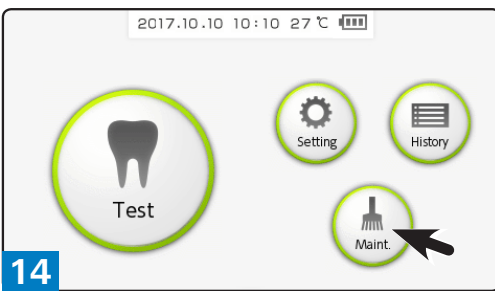

14

Clean test strip holder daily. Tap [Maint.] and [Clean].

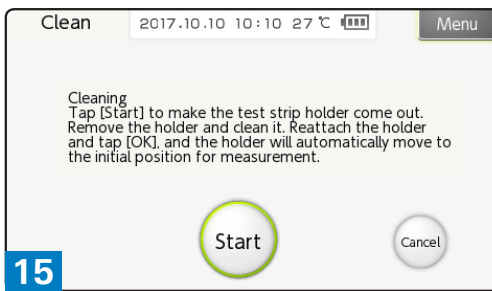

15

Follow instructions on Clean screens to remove and clean test strip holder.

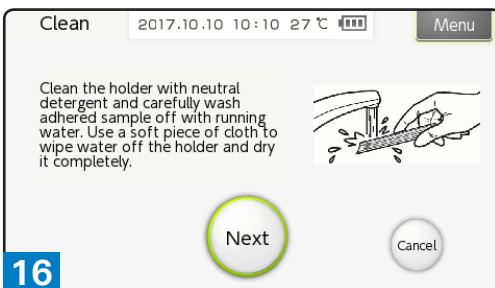

16

Follow instructions to clean test strip holder.

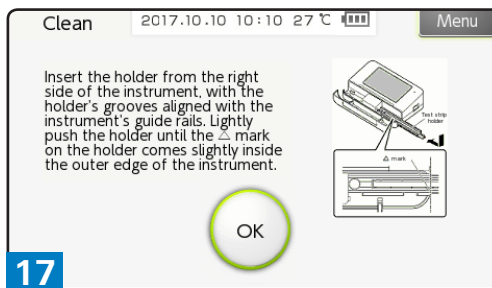

17

Note: If error messages appear, see Operating Manual for complete troubleshooting instructions.

CHECK MEASUREMENT ON THE SiLL-Ha INSTRUMENT

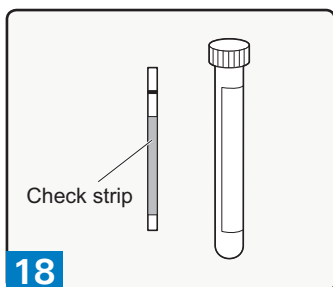

18

Remove one check strip from the container. Use one of the strips.

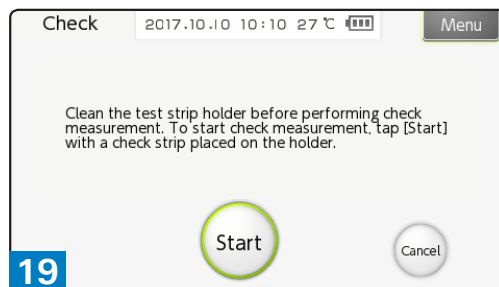

19

On the Top menu screen, tap [Maint.] and [Check], in that order. The Check screen will appear. Follow instructions on screen.

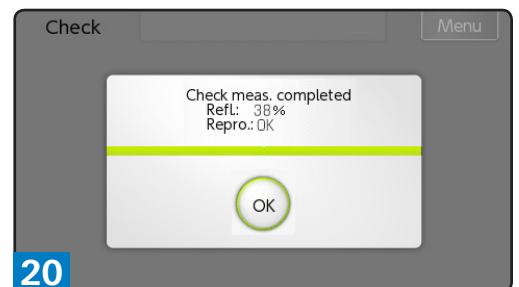

20

Verify the test results are within range printed on tube. Note: If error messages appear, see Operating Manual for complete troubleshooting instructions.

CHECK MEASUREMENT

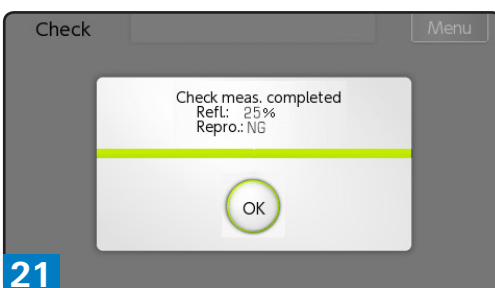

21

Outside the range: NG. There is a problem with the instrument. Contact the manufacturer.

TROUBLESHOOTING GUIDE



See Chapter 5 of the Operating Manual.